



# SPYDER

WWW.SPYDERAUTO.COM

## INSTALLATION GUIDE:

ALT-YD-BE9006-LED (ALL COLORS)

### Tools Required

8mm Socket w/ Ratchet  
Panel Popper or Flat-head Driver

*\*Please Note\**

If you are unfamiliar with the installation processes, professional installation is highly recommended.



1) Open your trunk and locate the access panel covering the tail lights. Twist the knob to unlock the panel and remove it.



2) Once the panel has been removed, locate the (3) 8mm bolts securing the tail light. Remove these and the tail light harness from the bulb bracket.

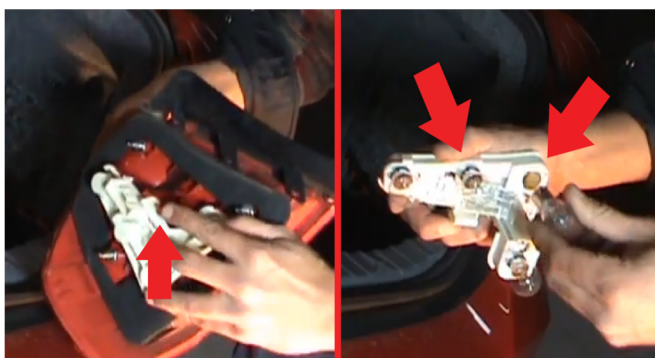

3) Next, remove the tail light and locate the tab on the bulb bracket, pinch the tab to remove it from the tail light. Next you will need to remove (2) bulbs from the bulb bracket. Bulbs that will need to be removed are indicated by the arrows shown.



4) Taking the new Spyder outer tail light housing, remove the lower two sockets and insert the (2) bulbs removed from the old tail light. Place them in the sockets and replace the sockets back into the tail light housing. Be sure to seat the sockets flush and properly to prevent any moisture in the tail light.

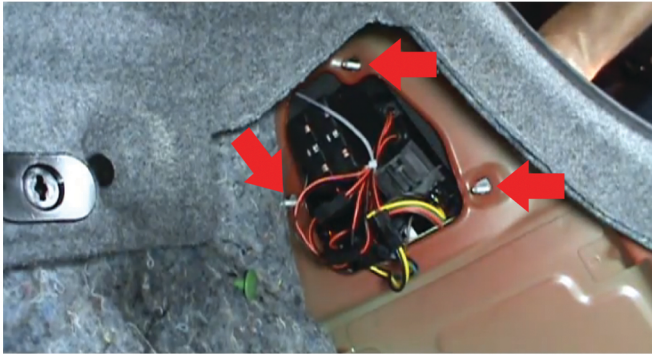

5) Next, seat the tail light onto the frame lining up the three bolt threads with their mount holes. Replace the (3) 8mm bolts. Once these are secure you can connect the wiring harnesses together.



7) The next step is similar to the corner tail light installation. Remove the bulbs indicated by the arrows shown. You will need to insert these in to the designated sockets on the new Spyder trunk tail light.

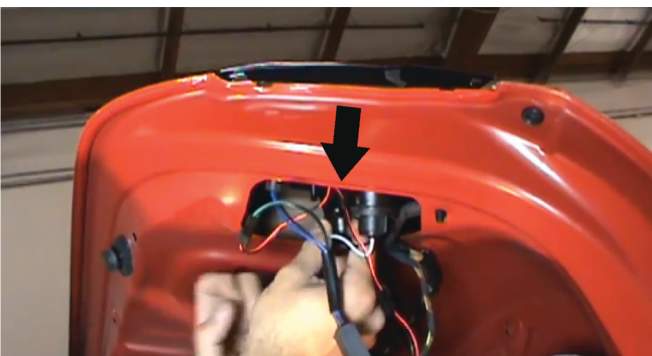

9) Next, seat the light on the trunk lining up the corners. To secure the light to the trunk you will need to install the bracket to hold the light onto the trunk then tie it down with the 8mm nut. Tighten the bolt down with the 8mm socket. The final step is to mount the resistor ballast. Peel off the red 3m plastic film and mount the resistor on a flush area. **Note:** be sure before mounting the resistor that the area is cleaned very well or it will not stick.



6) Now that the corner lights are complete you will need to install the trunk lights. Before you can get to the back housing of the trunk tail light you will need to remove several plastic fasteners that secure the trunk liner. Next, locate the 8mm nut that secures the light, unscrew this to remove.

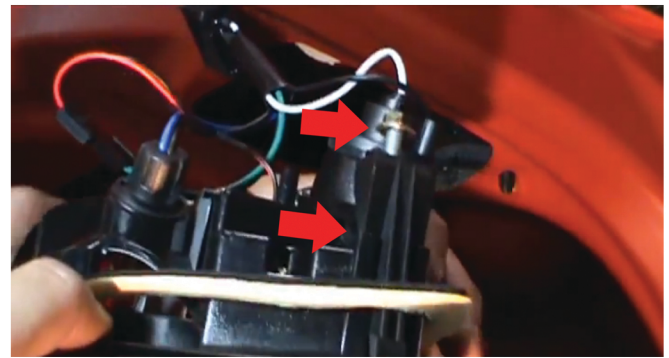

8) Once the bulbs are placed in the sockets and the sockets secured in the housing there will be a removable bracket and 8mm nut that you will need to remove before installing them on the car. Unscrew the nut to release the brackets as shown.



Congratulations on completing the installation for your new Spyder head lights for the 2006-2008 BMW E90 3 Series 4 door.



For further help with installation, please watch our installation video. Follow the direct link below to our YouTube channel for more information.  
<https://www.youtube.com/watch?v=d7hvmTRPQjg>

## Disclaimer

Spyder Auto Installation Guide is not liable for damages, injuries, and death while installing the product. This is intended to be an installation guide, to cut down installation time for you. We have no responsibility for improper installation, if you do not know how to install, please have a professional install it.